



504-362-0781 or 800-889-0781

2236 Manhattan Blvd. Harvey, LA 70058 Fax: 504-367-4216

Grade 80 Coupling Link

To assemble:

1. Put two halves of coupling link together as shown.
2. Put locking spacer between halves, line up with holes in coupling link.
3. Drive pin through holes in coupling link and locking spacer until flush with outside of coupling link

GRADE 80 ALLOY FITTINGS

GRADE 80 COUPLING LINK

Forged alloy steel, heat treated. According to ASTM A952

Sizes 9/32", 3/8" through 1.1/4"

Also available in DOMESTIC.

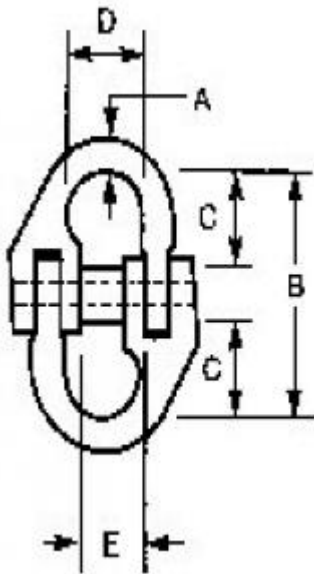

Size	Work Load Limit in lbs	Approx. Wt. ea. in lbs.	A	B	C	D	E
9/32"	3,500	.21	.33	1.93	.79	.79	.73
5/16"	4,500	.55	.37	2.75	1.02	.98	.89
3/8"	7,100	.77	.47	3.03	1.26	1.06	.98
1/2"	12,000	1.50	.61	3.34	1.38	1.26	1.18
5/8"	18,100	2.42	.73	4.05	1.69	1.53	1.42
3/4"	28,300	3.74	.90	4.56	1.89	1.85	1.73
7/8"	34,200	4.85	1.04	5.24	2.00	2.16	1.93
1"	47,700	9.26	1.24	5.83	2.36	2.60	2.36
